





A home to love

 2
  4
  3
  1

SHOWHOME

10 Caldera Drive, Long Bay, Auckland
Ph. 09 213 3936.

Effortless style, integrated living zones and interior flair make this an ideal family home.

Situated on Caldera Drive this beautiful, modern home has been specifically designed to maximise the stunning views, the natural light and the sun. This is the perfect home for those looking for unparalleled style and functionality.



Long Bay Showhome

10 Caldera Drive, Long Bay, Auckland
Ph. 09 213 3936.

Ph 0800 000 007 | davidreidhomes.co.nz



Designed for you

Lower Floor Plan

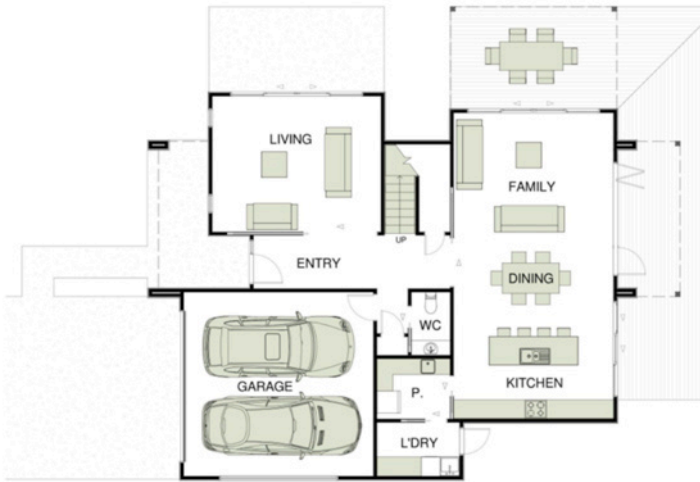

Total Area 287sqm

This home has been specifically designed to maximise the stunning views, the natural light and the sun.

The carefully considered design with central integrated living, allows the family to come together for casual family meals and entertainment, while the separate formal lounge and bedroom areas allows each member to enjoy their own space.

The living area is extended with large exterior decks and patios, allowing for the ultimate kiwi indoor/outdoor lifestyle.

Upper Floor Plan



Length	22m
Width	16m

Living

Living / Dining / Kitchen	5x9.7m
Lounge	5.3m x 4.3m
Office	3.1m x 1.7m

Bedrooms

Master	5m x 4.6m
Bed 2	3.1m x 3.5m
Bed 3	3.1m x 3.5m
Bed 4	3.2m x 3.2m

Garage

Garage	6m x 5.8m
Floor Area (over foundations)	251m ²
Covered outdoor living	36m ²
Total Area	287m ²

If you love the design of the house but want to change some aspects of the layout or specification then this can easily be done. Floor plans can also be mirrored to suit the building site. All plans are copyright and no part may be reproduced or copied without prior written consent from David Reid Homes.

Long Bay Showhome

10 Caldera Drive, Long Bay, Auckland
Ph. 09 213 3936.

Ph 0800 000 007 | davidreidhomes.co.nz



Designed
for you